



2,919

Sq.Ft.



4

Bedrooms



3.0

Bathrooms



1.0

Story



2

Garage

Growing and active families will find plenty of space and privacy in the La Salle. This sprawling home features three separated living quarters: a large master suite with plenty of walk-in closet space, a soaking tub, and double vanities; another smaller suite with a walk-in closet and full bathroom; and a pair of bedrooms with a shared full bathroom. The large kitchen, breakfast area, and family room make up the central gathering space, with a dedicated dining room near the front entrance. Covered porches create additional entertaining spaces at the front and rear, and an attached 2-car garage leads into a drop zone and utility room on the right.

WWW.TILSONHOMES.COM



*Tilson continuously improves home designs and reserves the right to modify home features and specifications without notice or obligation. Square footage is approximate and includes overall dimensions. Renderings are drawn to be substantially correct. Tilson standard features may vary by home design and/or location. Contact a Tilson Sales Associate for details.
Current information as Oct. 29, 2024, 12:48 p.m.*



Elevation B - The La Salle

WWW.TILSONHOMES.COM



*Tilson continuously improves home designs and reserves the right to modify home features and specifications without notice or obligation. Square footage is approximate and includes overall dimensions. Renderings are drawn to be substantially correct. Tilson standard features may vary by home design and/or location. Contact a Tilson Sales Associate for details.
Current information as Oct. 29, 2024, 12:48 p.m.*

Floor Plan | The La Salle

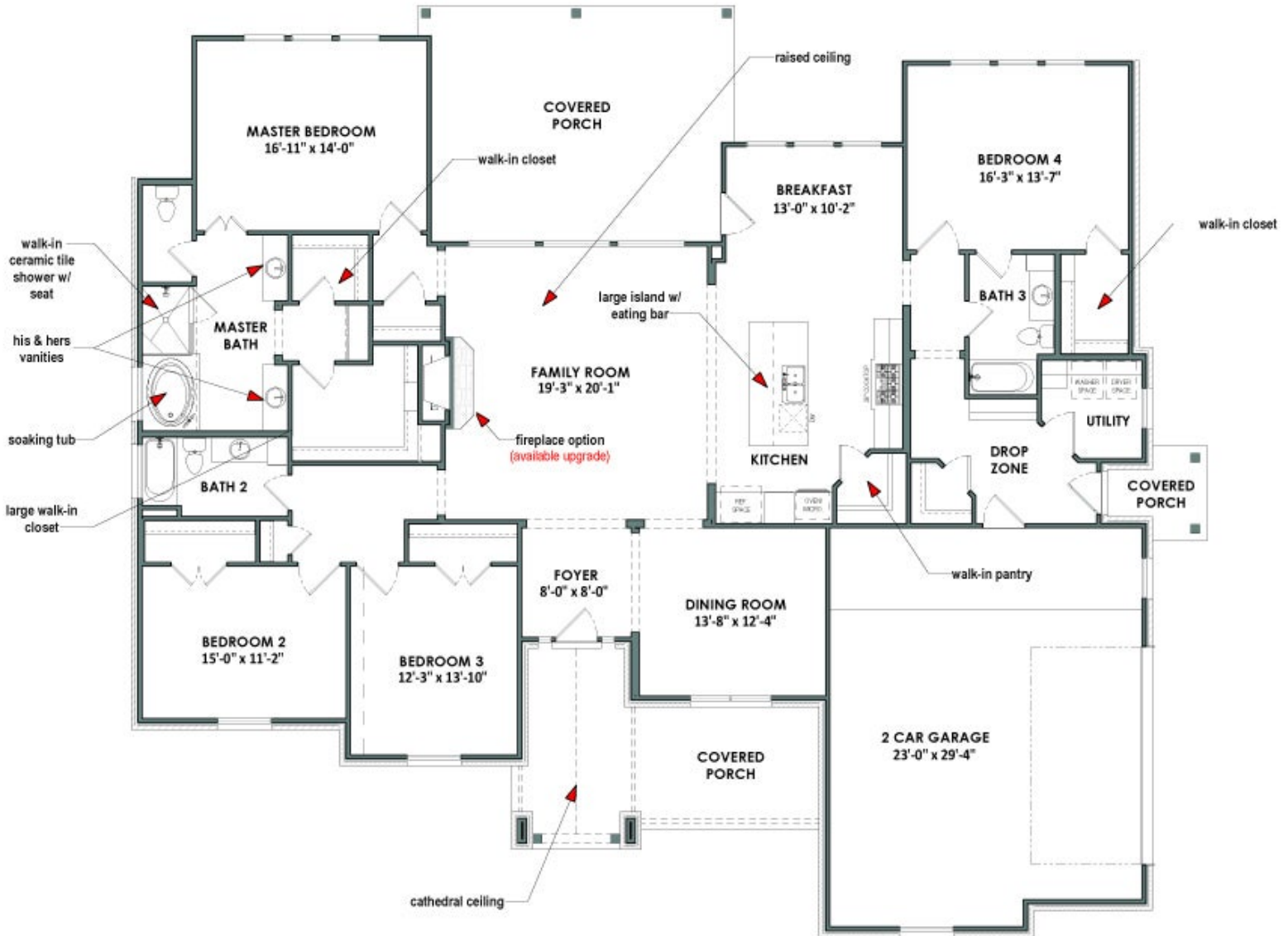

WWW.TILSONHOMES.COM



Tilson continuously improves home designs and reserves the right to modify home features and specifications without notice or obligation. Square footage is approximate and includes overall dimensions. Renderings are drawn to be substantially correct. Tilson standard features may vary by home design and/or location. Contact a Tilson Sales Associate for details. Current information as Oct. 29, 2024, 12:48 p.m.