



1,886

Sq.Ft.



3

Bedrooms



2.0

Bathrooms



1.0

Story



0

Garage

The Parker features a master suite with a soaking tub, dual vanities, and a large walk-in closet, separated from two additional bedrooms for privacy. Between them is a bright and cozy family room with a wall of windows viewing the rear covered porch and a half wall looking into the adjacent kitchen. In the kitchen, you'll find a large island with an eating bar, a spacious walk-in pantry in the corner, and an open dining room. The family room and kitchen connect to a hub leading to the utility room, second bathroom, and secondary bedrooms.

WWW.TILSONHOMES.COM



Tilson continuously improves home designs and reserves the right to modify home features and specifications without notice or obligation. Square footage is approximate and includes overall dimensions. Renderings are drawn to be substantially correct. Tilson standard features may vary by home design and/or location. Contact a Tilson Sales Associate for details. Current information as Nov. 15, 2024, 3:45 p.m.



Elevation D - The Parker

WWW.TILSONHOMES.COM



*Tilson continuously improves home designs and reserves the right to modify home features and specifications without notice or obligation. Square footage is approximate and includes overall dimensions. Renderings are drawn to be substantially correct. Tilson standard features may vary by home design and/or location. Contact a Tilson Sales Associate for details.
Current information as Nov. 15, 2024, 3:45 p.m.*

Floorplan - The Parker

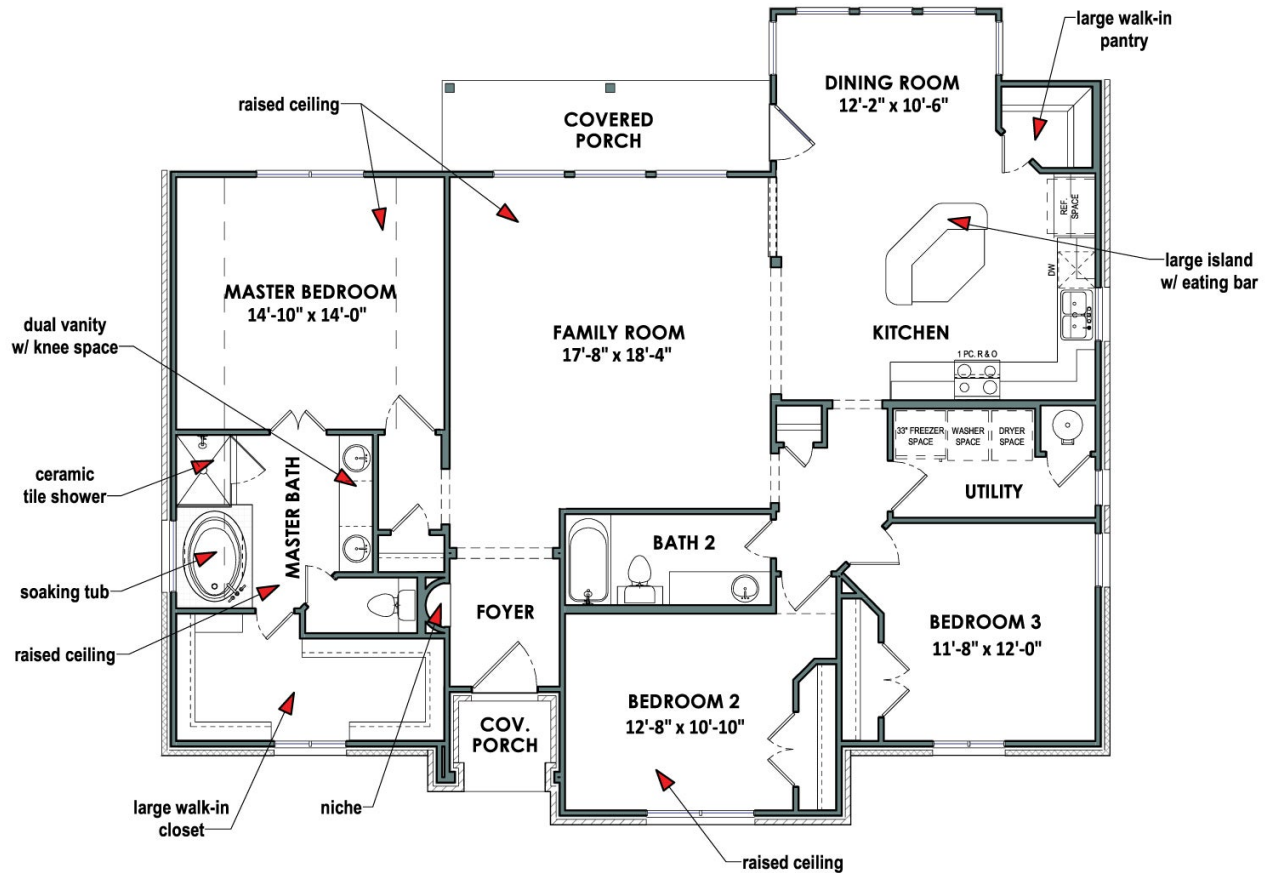

WWW.TILSONHOMES.COM



Tilson continuously improves home designs and reserves the right to modify home features and specifications without notice or obligation. Square footage is approximate and includes overall dimensions. Renderings are drawn to be substantially correct. Tilson standard features may vary by home design and/or location. Contact a Tilson Sales Associate for details. Current information as Nov. 15, 2024, 3:45 p.m.